

Transformed.

**ISO**

INTERNATIONAL ORGANIZATION FOR STANDARDIZATION

**ISO RECOMMENDATION  
R 1011**

**PHOTOGRAPHIC COLOUR PAPER  
FOR ROLL PAPER PRINTERS  
PREFERRED SIZES OF ROLLS**

**1st EDITION**

**March 1969**

**COPYRIGHT RESERVED**

The copyright of ISO Recommendations and ISO Standards belongs to ISO Member Bodies. Reproduction of these documents, in any country, may be authorized therefore only by the national standards organization of that country, being a member of ISO.

For each individual country the only valid standard is the national standard of that country.

Printed in Switzerland

Also issued in French and Russian. Copies to be obtained through the national standards organizations.

**PHOTOGRAPHIC COLOUR PAPER  
FOR ROLL PAPER PRINTERS  
PREFERRED SIZES OF ROLLS**

**1. SCOPE**

This ISO Recommendation specifies the sizes and gives the slitting tolerances of photographic colour paper (positive and reversal) in rolls for machine printers.

**2. PREFERRED WIDTHS AND TOLERANCES**

Nominal width		Slitting width and tolerances			
centimetres	inches	millimetres		inches	
7.6	3	76.2	-0.8	3.00	-0.03
8.9	3 $\frac{1}{2}$	88.9	-0.8	3.50	-0.03
10.8	4 $\frac{1}{4}$	108.0	-0.8	4.25	-0.03
12.7	5	127.0	-1.0	5.00	-0.04
20.3	8	203.2	-1.0	8.00	-0.04
25.4	10	254.0	-1.0	10.00	-0.04

**3. LENGTHS OF ROLLS AND SPLICES PERMITTED**

Recommended nominal length of rolls		Permissible number of splices
metres	feet	
75 —	— 250	2
150 —	— 500	3

**4. LENGTH ALLOWANCE FOR SPLICES**

In rolls containing splices, an additional length at least equal to the *A* dimension used (see Figure) plus 15 cm (6 in) should be provided per splice; the value 15 cm (6 in) is increased to 30 cm (12 in) for rolls over 12.7 cm (5 in) wide.

## 5. BASIS OF SIZE CHECKING

Any check of dimensions should be made on unprocessed paper taken from a previously unopened package and exposed for at least 2 hours to a temperature of  $20 \pm 2^\circ\text{C}$  and a relative humidity of  $55 \pm 5\%$ .

## 6. SPLICE WARNING

Means for detecting each splice should be provided in the form of a long hole or slot in the paper. Recommended dimensions and location of the slot are given in the Figure.

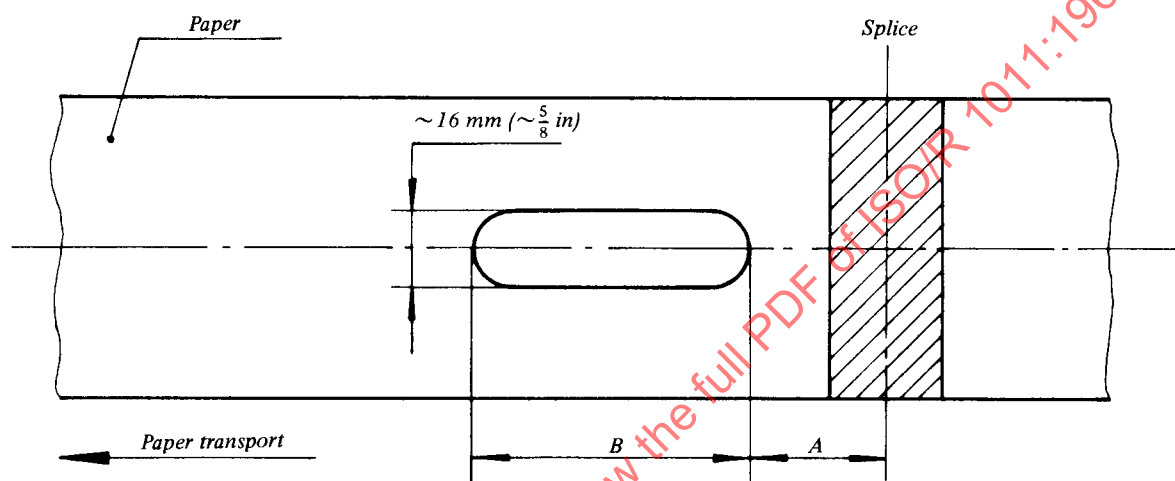

FIGURE – Slot used for splice detection

$$A = 25 \text{ to } 104 \text{ mm (1 to 4 in)}$$

$$B = 75 \pm 20 \text{ mm (3.0} \pm 0.8 \text{ in)}$$

## 7. ROLL PAPER CORES

The preferred inside diameter of cores for roll paper is

$$76.4^{+2.0}_0 \text{ mm (3.01}^{+0.08}_0 \text{ in)}$$

## 8. WINDING

The labelling should indicate whether the paper is wound emulsion in or emulsion out.