

REV.
F

AS933™

FEDERAL SUPPLY CLASS
4730

RATIONALE

ADDED CADMIUM WARNING NOTE. REFERENCED STANDARDS UPDATED TO CURRENT NOMENCLATURE. UPDATED QML NOTE TO CURRENT WORDING AND INCLUDED PROC SPEC AS4875 FOR THE STRAIGHT THREADED END. INTENDED NOTE REVISED POINTING THE USER TO REFER TO THE PROCUREMENT SPECIFICATION FOR APPLICABLE PRESSURES. NOTE 16 REVISED.

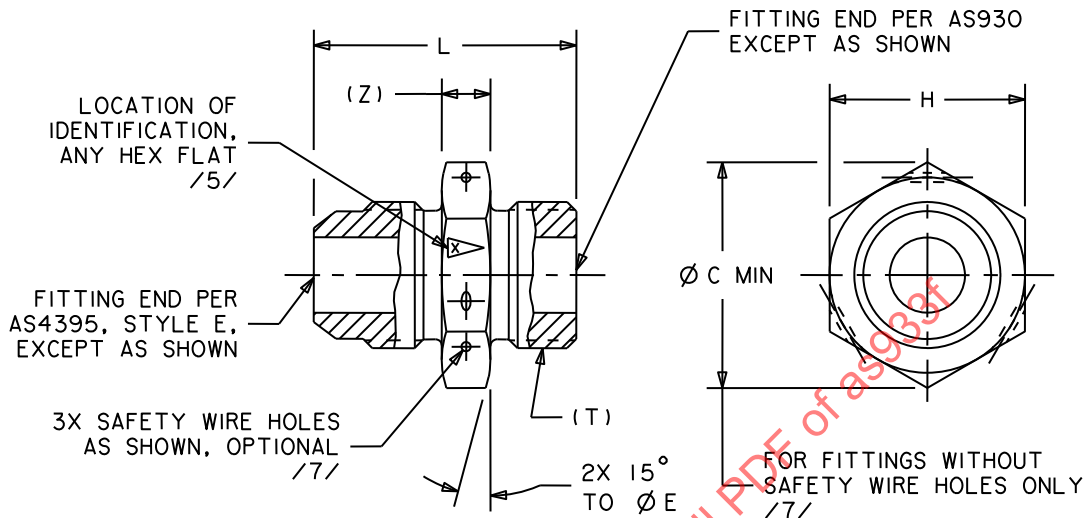

FIGURE 1 - FITTING, ADAPTER, UNION

TABLE 1 - DIMENSIONS AND WEIGHTS

BASIC NO. AS933 /15/ SIZE CODE	(NOMINAL TUBE SIZE)	T THREAD PER AS8879 CLASS 3A	C	E ±.010	H	L	Z	LB/EA APPROX REF AL	LB/EA APPROX REF STEEL	LB/EA APPROX REF TI
02	.125	.3125-24 UNJF	.638	.542	.552-.565	1.028	.220	.0113	.0323	.0178
03	.188	.3750-24 UNJF	.709	.605	.615-.628	1.059	.220	.0146	.0420	.0232
04	.250	.4375-20 UNJF	.780	.668	.678-.691	1.185	.235	.0198	.0567	.0313
05	.312	.5000-20 UNJF	.851	.730	.740-.753	1.185	.235	.0234	.0672	.0371
06	.375	.5625-18 UNJF	.922	.792	.802-.815	1.206	.250	.0275	.0790	.0436
08	.500	.7500-16 UNJF	1.120	.980	.990-1.003	1.347	.250	.0498	.143	.0790
10	.625	.8750-14 UNJF	1.260	1.103	1.113-1.128	1.510	.312	.0727	.209	.115
12	.750	1.0625-12 UNJ	1.540	1.353	1.363-1.380	1.719	.375	.122	.350	.193
16	1.000	1.3125-12 UNJ	1.788	1.603	1.613-1.630	1.766	.375	.164	.472	.260
20	1.250	1.6250-12 UNJ	2.063	1.853	1.863-1.880	1.813	.375	.232	.666	.367
24	1.500	1.8750-12 UNJ	2.338	2.099	2.109-2.135	1.938	.375	.299	.857	.473
32	2.000	2.5000-12 UNJ	3.025	2.724	2.734-2.760	2.250	.437	.592	1.70	.938

INACTIVE IN PART - SEE NOTE /16/

For more information on this standard, visit
<https://www.sae.org/standards/content/AS933F/>

THIRD ANGLE PROJECTION

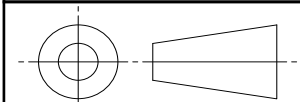

CUSTODIAN: G-3/G-3B

PROCUREMENT SPECIFICATION: AS4841 /4/



AEROSPACE STANDARD

FITTING, ADAPTER, UNION,
FLARED TO BOSS

AS933™
SHEET 1 OF 3

REV.
F

NOTES:

THIS DOCUMENT REFERENCES A PART WHICH CONTAINS CADMIUM AS A PLATING MATERIAL. CONSULT LOCAL OFFICIALS IF YOU HAVE QUESTIONS CONCERNING CADMIUM'S USE.

/1/ MATERIAL:

- a. DASH AS CODE LETTER: TYPE 4130 STEEL BAR PER AMS-S-6758 OR AMS6370. TYPES 1137 AND 1141 CARBON STEEL ARE SUPERSEDED BY TYPE 4130. /2/
- b. CODE LETTER D: TYPE 2024-T6 ALUMINUM ALLOY BAR PER AMS-QQ-A-225/6, OR TYPE 2024-T851 ALUMINUM ALLOY BAR PER AMS-QQ-A-225/6 OR AMS4339.
- c. CODE LETTER J: TYPE 304 CORROSION RESISTANT STEEL BAR PER AMS-QQ-S-763 OR AMS5639.
- d. CODE LETTER K: TYPE 316 CORROSION RESISTANT STEEL BAR PER AMS-QQ-S-763 OR AMS5648.
- e. CODE LETTER R: TYPE 321 CORROSION RESISTANT STEEL BAR PER AMS-QQ-S-763 OR AMS5645.
- f. CODE LETTER S: TYPE 347 CORROSION RESISTANT STEEL BAR PER AMS-QQ-S-763 OR AMS5646. /16/
- g. CODE LETTER T: TYPE 6AL-4V TITANIUM ALLOY BAR PER AMS4928.
- h. CODE LETTER W: TYPE 7075-T73 ALUMINUM ALLOY BAR PER AMS-QQ-A-225/9, OR TYPE 7075-T7351 ALUMINUM ALLOY BAR PER AMS4124.

/2/ HEAT TREATMENT:

- a. DASH AS CODE LETTER: SEE HARDNESS REQUIREMENT PER PROCUREMENT SPECIFICATION.
- b. OTHER MATERIAL CODE LETTERS: NONE.

3. FINISH:

- a. DASH AS CODE LETTER: CADMIUM PLATE PER AMS-QQ-P-416, TYPE II, CLASS 2, DYE BLACK AND COAT WITH A LIGHT FILM OF OIL PER PROCUREMENT SPECIFICATION. /14/
- b. MATERIAL CODE LETTER D:
 - 1. ANODIZE PER AMS2472 OR MIL-PRF-8625, TYPE II, CLASS 2, DYE BLUE, DUPLEX SEAL PER PROCUREMENT SPECIFICATION.
 - 2. D CODE PARTS TO BE COATED WITH HIGH PURITY ALUMINUM ONLY WILL HAVE THE FINISH CODE LETTER "V" AFTER THE SIZE CODE IN THE PART NUMBER. THE FINISH WILL BE: COAT WITH HIGH PURITY ALUMINUM PER MIL-DTL-83488, CLASS 3, TYPE II WITH MAXIMUM COATING THICKNESS OF .0005. GLASS BEAD PEEN PRESSURE SHALL BE 25 PSI MAXIMUM.
- c. MATERIAL CODE LETTER J: PASSIVATE PER AMS2700, TYPE 6 OR 7.
- d. MATERIAL CODE LETTER K: PASSIVATE PER AMS2700, TYPE 6 OR 7.
- e. MATERIAL CODE LETTER R: PASSIVATE PER AMS2700, TYPE 6 OR 7.
- f. MATERIAL CODE LETTER T: ANODIZE PER AMS2488 OR FLUORIDE PHOSPHATE CONVERSION COAT PER AMS2486 WITH COLOR PER PROCUREMENT SPECIFICATION.
- g. MATERIAL CODE LETTER W:
 - 1. ANODIZE PER AMS2472 OR MIL-PRF-8625, TYPE II, CLASS 2, DYE BROWN, DUPLEX SEAL PER PROCUREMENT SPECIFICATION.
 - 2. W CODE PARTS TO BE COATED WITH HIGH PURITY ALUMINUM ONLY WILL HAVE THE FINISH CODE LETTER "V" AFTER THE SIZE CODE IN THE PART NUMBER. THE FINISH WILL BE: COAT WITH HIGH PURITY ALUMINUM PER MIL-DTL-83488, CLASS 3, TYPE II WITH MAXIMUM COATING THICKNESS OF .0005. GLASS BEAD PEEN PRESSURE SHALL BE 25 PSI MAXIMUM.

	AEROSPACE STANDARD	AS933™ SHEET 2 OF 3	REV. F
	FITTING, ADAPTER, UNION, FLARED TO BOSS		